

## FEATURES

Five year limited warranty.  
Forged brass manifold with an exclusive lifetime warranty.  
Large capacity, die-cast, anodized aluminum oil-bath crankcase.  
Over-sized connecting rods for maximum life.  
Heavy-duty tapered roller bearing.  
Solid ceramic plungers with mirror finish and corrosion resistance.  
Stainless steel inlet and discharge valve assemblies.  
Forged valve caps with recessed O-rings.  
Dacromet® coated manifold bolts for extra corrosion resistance.



## SPECIFICATIONS

| PUMP MODEL                    | KX 8030                  | KX 1025 |
|-------------------------------|--------------------------|---------|
| Maximum Volume (GPM)          | 8                        | 10.6    |
| Max. Discharge Pressure (PSI) | 3000                     | 2500    |
| Maximum Pump Speed            | 1460                     | 1725    |
| Maximum Inlet Pressure        | 125 psi                  |         |
| Maximum Inlet Vacuum          | 9 ft. water (7.9 in. Hg) |         |
| Bore                          | 25mm                     | 25mm    |
| Stroke                        | 15mm                     | 17mm    |
| Crankcase Oil Capacity        | 40 oz.                   |         |
| Maximum Fluid Temperature     | 165° F                   |         |
| Inlet Port Thread             | 3/4" BSP                 |         |
| Discharge Port Thread         | 1/2" BSP                 |         |
| Shaft Diameter x Shaft Length | 25mm x 55mm              |         |
| Weight                        | 39 lbs                   |         |
| Dimensions (L x W x H)        | 12.85 x 10.23 x 6.45     |         |

# KÄRCHER KX Series Pump

9.803-400.0 KX 8030 Right  
9.803-401.0 KX 8030 Left  
9.803-402.0 KX 1025 Right  
9.803-403.0 KX 1025 Left

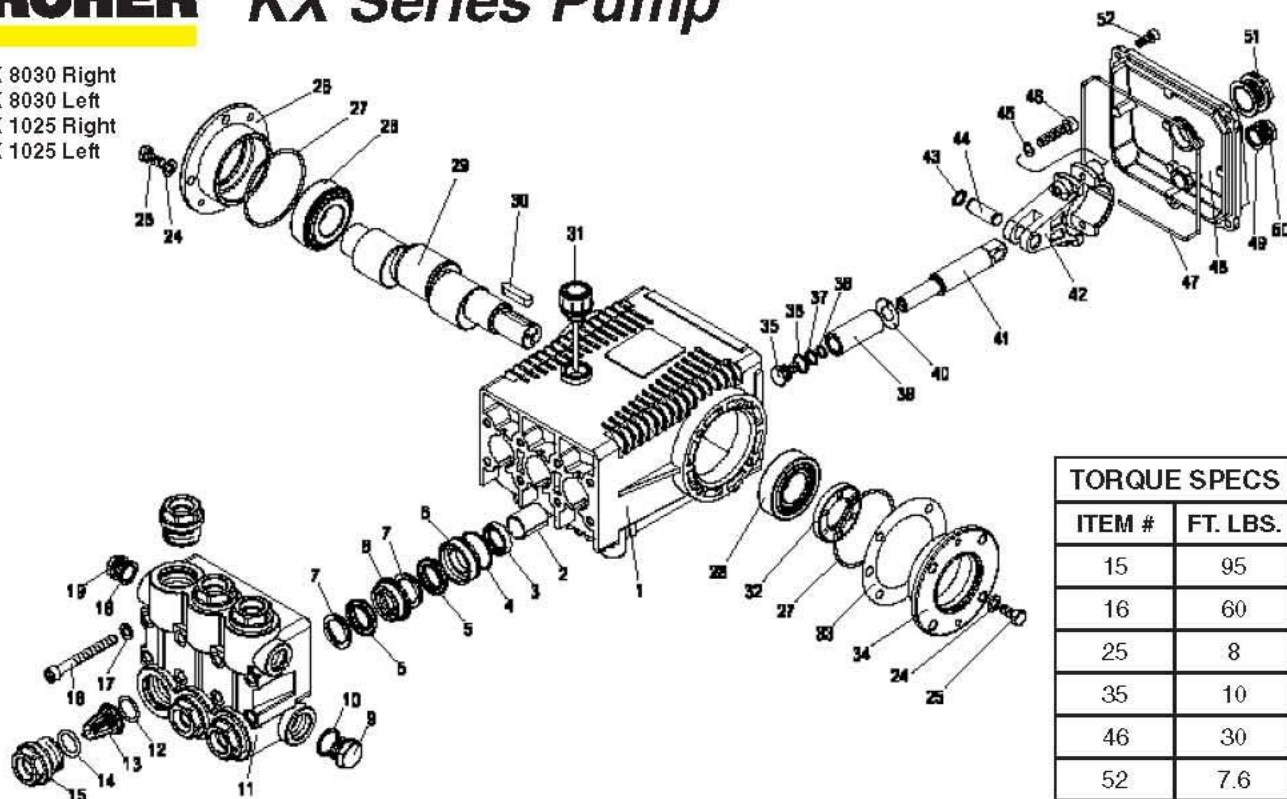

| TORQUE SPECS |          |
|--------------|----------|
| ITEM #       | FT. LBS. |
| 15           | 95       |
| 16           | 60       |
| 25           | 8        |
| 35           | 10       |
| 46           | 30       |
| 52           | 7.6      |

## PARTS LIST

| ITEM | PART NO.      | DESCRIPTION          | QTY | ITEM | PART NO.    | DESCRIPTION            | QTY | ITEM | PART NO.      | DESCRIPTION           | QTY |
|------|---------------|----------------------|-----|------|-------------|------------------------|-----|------|---------------|-----------------------|-----|
| 1    | 9.803-163.0   | Crankcase            | 1   | 18   | 9.803-199.0 | Copper Washer 1/2      | 1   | 37*  | 9.803-187.0   | O-Ring Ø1.78x10.82    | 3   |
| 2    | 9.803-195.0   | Plunger Guide        | 3   | 19   | 9.802-926.0 | Brass Plug 1/2         | 1   | 38*  | 9.803-187.0   | Teflon Ring           | 3   |
| 3*   | See Kit Below | Plunger Oil Seal     | 3   | 24   | 9.802-884.0 | Washer                 | 8   | 39*  | See Kit Below | Plunger 25mm          | 3   |
| 4*   | 9.803-190.0   | O-Ring Ø1.78 x 37.82 | 3   | 25   | 9.802-944.0 | Flange Screw           | 8   | 40*  | 9.802-887.0   | Copper Spacer         | 3   |
| 5*   | See Kit Below | V Seal, Dia. 25mm    | 6   | 26   | 9.803-182.0 | Closed Bearing Housing | 1   | 41   | 9.803-143.0   | Plunger Rod           | 3   |
| 6*   | 70-120110     | Pressure Ring 25mm   | 3   | 27   | 9.803-186.0 | O-Ring Ø2.62 x 71.12   | 2   | 42   | 9.803-157.0   | Connecting Rod        | 3   |
| 7*   | 70-030002     | Support Ring 25mm    | 6   | 28   | 9.803-160.0 | Roller Bearing         | 2   | 43   | 9.802-912.0   | Snap Ring             | 6   |
| 8*   | 70-030015     | Intermediate Ring    | 3   | 29   | 70-000447   | Crankshaft (KX 8030)   | 1   | 44   | 9.802-915.0   | Connecting Rod Pin    | 3   |
| 9    | 70-160133     | Brass Plug, 3/4      | 1   |      | 70-000474   | Crankshaft (KX 1025)   | 1   | 45   | 9.802-889.0   | Spring Washer         | 6   |
| 10   | 70-060311     | Copper Washer 3/4    | 1   | 30   | 9.803-167.0 | Crankshaft Key         | 1   | 46   | 70-180101     | Connecting Rod Screw  | 6   |
| 11   | 70-160223     | Manifold Housing     | 1   | 31   | 9.802-923.0 | Oil Dip Stick          | 1   | 47   | 9.803-194.0   | O-Ring Ø2.62 x 152.07 | 1   |
| 12*  | 70-060105     | O-Ring Ø2.62 x 23.47 | 6   | 32   | 9.803-139.0 | Crankshaft Seal        | 1   | 48   | 9.803-166.0   | Crankcase Cover       | 1   |
| 13*  | See Kit Below | Valve Assembly       | 6   | 33   | 9.803-177.0 | Shim                   | 2   | 49   | 9.803-197.0   | Gasket, G3/8          | 1   |
| 14*  | 70-060187     | O-Ring Ø3.53 x 25.80 | 6   | 34   | 9.803-181.0 | Bearing Housing        | 1   | 50   | 9.802-925.0   | Brass Plug 3/8        | 1   |
| 15   | 70-160145     | Valve Plug           | 6   | 35*  | 9.803-235.0 | Plunger Bolt           | 3   | 51   | 9.803-202.0   | Sight Glass G3/4      | 1   |
| 16   | 70-180133     | Manifold Stud Bolt   | 8   | 36*  | 9.802-886.0 | Copper Spacer          | 3   | 52   | 9.802-939.0   | Cover Screw           | 5   |
| 17   | 9.802-890.0   | Lock Washer          | 8   |      |             |                        |     |      |               |                       |     |

\* Available in kit (See below)

## REPAIR KITS

| KIT NUMBERS                          | 9.802-612.0           | 9.802-613.0          | 9.802-614.0               | 9.802-608.0    | 9.802-606.0       |
|--------------------------------------|-----------------------|----------------------|---------------------------|----------------|-------------------|
| KIT DESCRIPTION                      | Plunger Seal<br>25 mm | Seal Packing<br>25mm | Plunger<br>25mm           | Complete Valve | Plunger Oil Seals |
| ITEMS NUMBERS INCLUDED               | 4, 5, 7               | 4, 5, 6, 7, 8        | 35, 36, 37, 38,<br>39, 40 | 12, 13, 14     | 3                 |
| NUMBER OF CYLINDERS KIT WILL SERVICE | 3                     | 1                    | 1                         | 6              | 3                 |